

CHATELAINE ROAD RESURFACE BEGINS

In the past five years Chatelaine has undergone a significant transformation with the completion of sixteen new townhomes. During that same period of time, the forty existing residences have been painted and have had roofs replaced. Two of the four remaining lots are now under contract.

Last year the focus shifted to common areas project with the landscaping of the East and West cul da sacs and the structural repairs and plumbing upgrades to the fountain. While there is still ongoing work to be done with irrigation and landscaping, the last major phase of the revitalization of Chatelaine will take place in mid October with the replacement of the road surface of Castellan Drive.

The Road Committee in consultation with King Asphalt determined that for minimal disruption and the safety of the community, the **complete** shut down of Castellan Drive would be required for a three-day period. Offsite parking and transportation will be provided. Police will handle traffic control on Old Boiling Springs Road.

Information link. <http://www.nhenterprises.com/hoa/Chatelaine/photos.com>

Schedule: Pre-construction

*10/4 to 10/10 various underground works on utilities such as: water taps, storm drains and curb repair will be completed also safety meeting with Fire Marshall and King. **(Road open to traffic with minor inconveniences)**

Schedule: Construction

- 10/12 8:00am Castellan Drive **will be closed to all traffic.**
- 10/12 8:30am to 6:00pm grinding and remove existing 4" asphalt and repair of sub base.
- 10/13 7:00 am to 5:00pm install 2" base and top coat asphalt.
- 10/14 7:00 am to 5:00pm install 2" top coat asphalt. 5:00pm Open road to traffic.

Off Site Parking

Thanks to the cooperation of both the business community and your apartment neighbors, parking has been established in the local area. Three parking areas are available: Oak Ridge Apts (Lots A, B,), behind MG Grand Spa (Lot C) and Milestone Office Park (Lot D). All lots are a short walk if you like the exercise. **See the attached map for exact lot locations and a dashboard sign. Please place road sign on your dashboard to prevent towing.**

Two Shuttle Services to Parking Areas

Shuttle Bus- a 12 passenger shuttle will park outside the emergency gate at the East cul de sac, it will provide transportation to the designated off site parking. When you return to the lot, simply call the shuttle for a pick up, remember to tell him your parking lot number. The driver's phone number is 569-8046 (service hours 7:00am to 11:30pm) **Minimal groceries please.**

Golf Cart – a 6 passenger shuttle is also available along the 15th fairway at Thornblade to take you to the Shuttle Bus. The driver's phone is 569-8126 tell him your residence number and walk to the cart path for pick up.

Suspension of services

Mail delivery- per postmaster, postal service will attempt to deliver mail each day, if unsuccessful mail will be delivered the subsequent day, until delivered. Mail can also be picked up at Greer post office on Pennsylvania Ave.

Trash Service- Cancelled for week of 10/11, resume the following week.

Sprinkler Systems- turn off your private system during road work.

Newspaper- notified to check for road access each day.

Personal Contractors- no access available per schedule.

Questions or Emergency Contact (non-medical or fire)

Any Board member, phone number in directory.

Note: "Tack" or tar used in resurfacing will be carried on truck tires and you can track it to concrete driveway, if this is a concern, park on a tarp.



Cave Ridge at Pelham

Apartment Homes

Old Boiling Springs Road

CART PATH

CART PICK UP AREAS

CASTELLAN



CASTELLAIN PARKING AREAS

- (A)
- (B)
- (C)
- (D)

CART PATH

MAN PICKUP AREA
FRETING THE RIBBON GATE

GATE

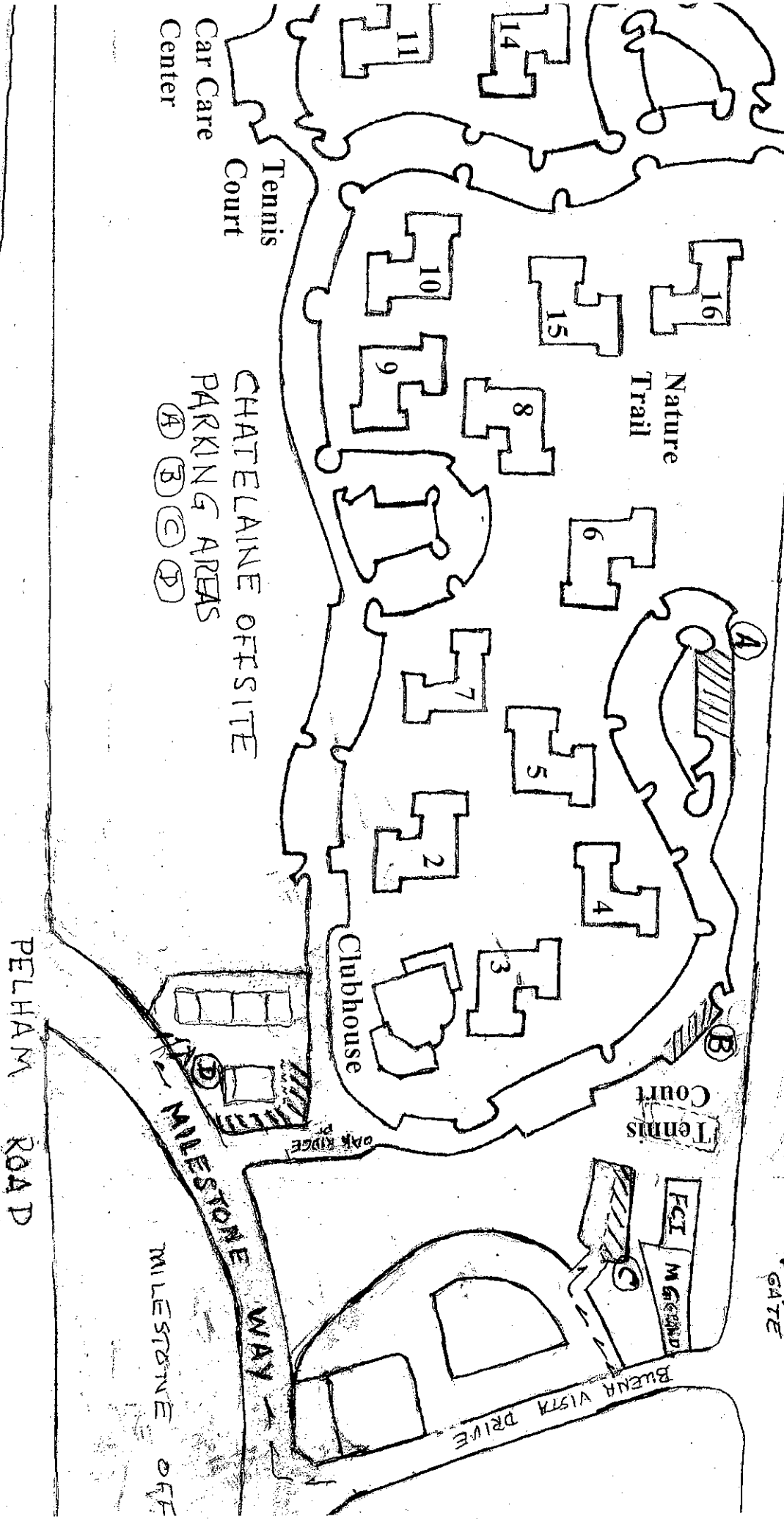

Tennis Court

FCI MGRND

BUENA VISTA DRIVE

Tennis Court

Car Care Center

CHATELAINNE OFFSITE
PARKING AREAS

- (A)
- (B)
- (C)
- (D)

MILESTONE WAY

MILESTONE OFF

PELHAM ROAD

DASHBOARD TAG

CHATELAIN

PAVING

FOR TRANSPORT CALL
589-8046 FOR VAN